

**Technical Features**

- › High flow rate up to 120 l/min
- › Four pressure ranges
- › Stable function over the entire flow range with quick response to the pressure changes
- › Failure resistant design
- › Low leakages of closed valve thanks to quality material of seat and hardened poppet
- › In the standard version, the valve is zinc-coated for 240 h protection acc. to ISO 9227

**Functional Description**

SIC pressure relief valve, direct acting, is intended to set maximum pressure in the circuit and protect the hydraulic circuits against overloading. The hardened poppet is pressed to the sealing edge of seat by spring force. The valve is closed in the basic position. If the system pressure exceeds the value of cracking pressure, set by compressing the spring, the poppet is pushed out of the seat and the circuit is relieved by the fluid draining to the tank. After the pressure drop in the circuit, the valve closes again.



**Technical Data**

Valve size / Cartridge cavity		1-1/16 12 UN / CA2
Max. flow	l/min (GPM)	120 (32)
Max. operating pressure	bar (PSI)	350 (5100)
Fluid temperature range (NBR)	°C (°F)	-20 ... +90 (-4 ... 194)
Weight	kg (lbs)	0.30 (0.66)

	Datasheet	Type
General information	GI_0060	Products operating conditions
Cavity details / Form tools	SMT_0019	SMT-CA2*
Spare parts	SP_8010	

**Characteristics** measured at  $v = 32 \text{ mm}^2/\text{s}$  (156 SUS)

**Relief pressure related to flow rate**

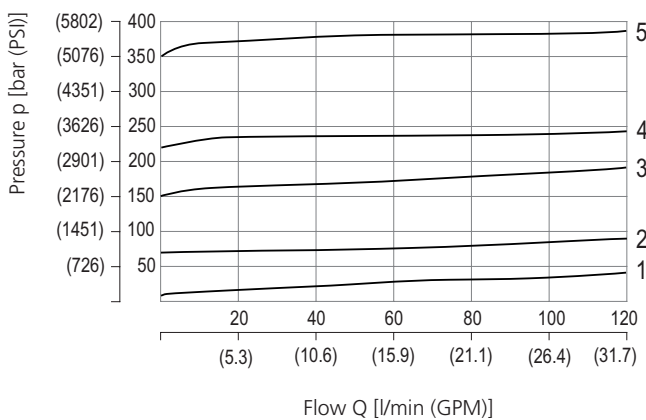

	Pressure range	Adjustable pressure range
5	35	230-350 bar
4	23	150-230 bar
3	15	70-150 bar
2	7	10-70 bar
1	7	$\Delta p$

Dimensions in millimeters (inches)

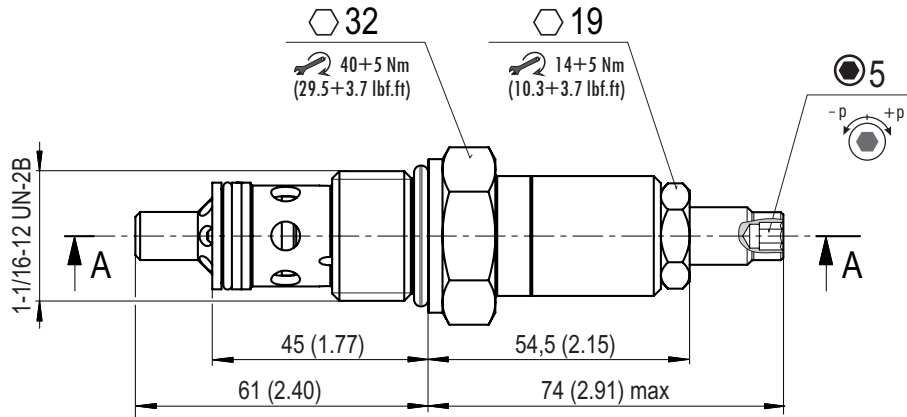

Cavity Details

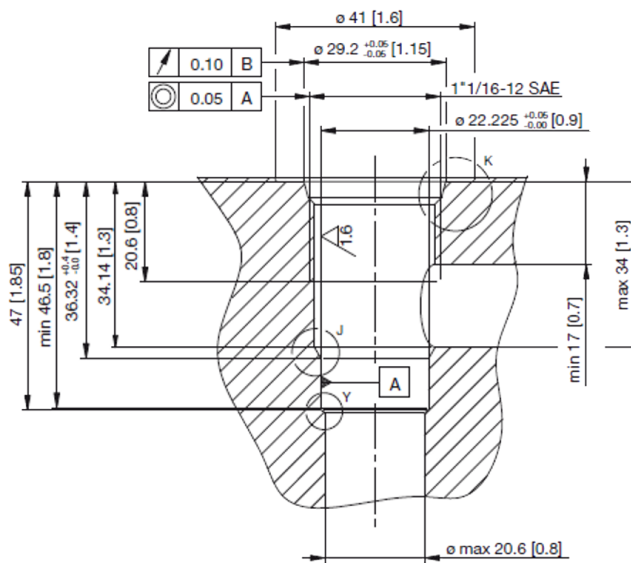

Ordering Code

SR1A-CA2 / H  S  - A

Pressure relief valve, poppet type, direct acting

Valve cavity  
1-1/16-12 UN / CA2

Model  
High performance

Pressure range  
adjustable pressure 10-70 bar (150-1000 PSI) **7**  
adjustable pressure 70-150 bar (1000-2200 PSI) **15**  
adjustable pressure 150-230 bar (2200-3350 PSI) **23**  
adjustable pressure 230-350 bar (3350-5100 PSI) **35**

Surface treatment\*  
zinc-coated (ZnCr-3), ISO 9227 (240 h)

\*For alternative surface treatment contact our technical support.

No designation

Seals  
NBR

Adjustment option  
allen key (hex. 5), without protective cap